

The New Martin Army

Martin Army Community Hospital’s modern campus features three patient care areas: the Upatoi and Oak Ridge Clinics, and the main Hospital tower.

Patients and visitors may park in the Visitor garage for easy access to the Main Entrance and clinic buildings.

The new Martin Army Community Hospital will reflect the mission of the legacy facility: to provide world class healthcare, using the best clinical and business practices, in a culture of professionalism and excellence. Martin Army strives to improve the health of the Fort Benning military community and beneficiaries by deploying the most qualified team of caregivers, ancillary service providers, and hospital administrators to promote a positive patient care and educational environment for our community.

For more information, visit us at:  
<https://www.facebook.com/#!/pages/Martin-Army-Community-Hospital/106090889433774>

**Sixth Floor**

Hospital	<div></div> Medical/Surgical Ward
	<div></div> Intensive Care Unit (ICU)

**Fifth Floor**

Hospital	<div></div> Labor & Delivery Ward
	<div></div> Mother Baby Unit
	<div></div> Women’s Health Clinic

**Fourth Floor**

Hospital	<div></div> Inpatient Behavioral Health
	<div></div> Intensive Outpatient Therapy (IOP)
	<div></div> Outpatient Behavioral Health
	<div></div> Family Advocacy Program (FAP)

**Legend**

- Public Elevator
- Public Restroom
- Public Stairs
- Service Elevators

**Basement**

Upatoi Clinic	<div></div> Administration Areas	Hospital	<div></div> Patient Admin Div (PAD)	
	Command Group		<div></div> Dept of Pathology	
	Hospital Education Div (HED)		<div></div> Information Mgmt Div (IMD)	
	Human Resources			
	Operations & Training Div (OTD)			
	Public Affairs Office			
	Quality Mgmt Div (QMD)			
	Resource Mgmt Div (RMD)			
	<div></div> Baugh Conference Room			

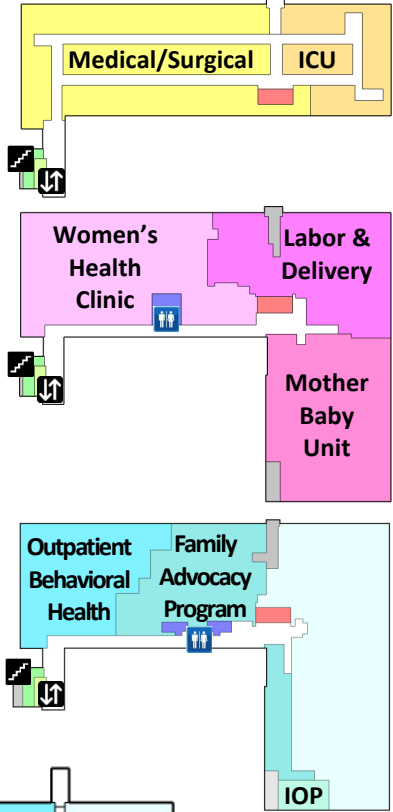

# Martin Army Community Hospital

Fort Benning, Georgia

Call Center: 762-408-CARE (2273)

Information Desk: 762-408-2604/2605

# Building Directory

# Martin Army Community Hospital—Fort Benning, GA

The main patient areas are listed below. Outpatient services are also offered on the Fourth (Behavioral Health) and Fifth (Women’s Health) floors of the Hospital tower.

For assistance with directions throughout the facility, ask at the Information Desk (i) or any staff member.

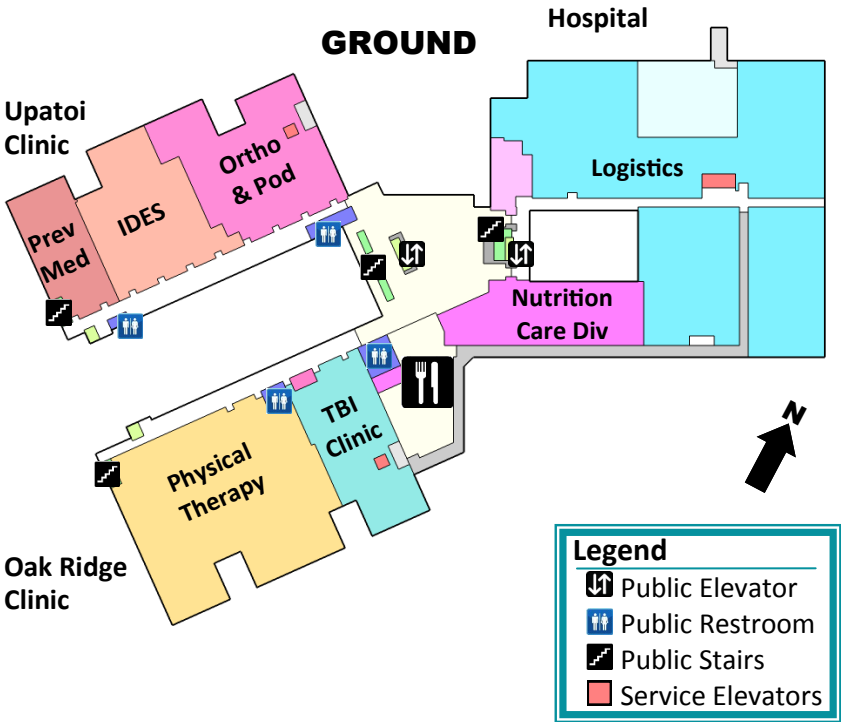

Ground Floor	
Hospital	Logistics
	Sterile Processing Division
	Nutrition Care Division
	Martin Café
Upatoi Clinic	Medical Library (Public)
	Dept of Preventive Medicine
	Integrated Disability Evaluation System (IDES)
	Orthopedics & Podiatry
Oakridge Clinic	Physical Therapy
	Chiropractic Service
	Occupational Therapy
	Traumatic Brain Injury (TBI) Clinic

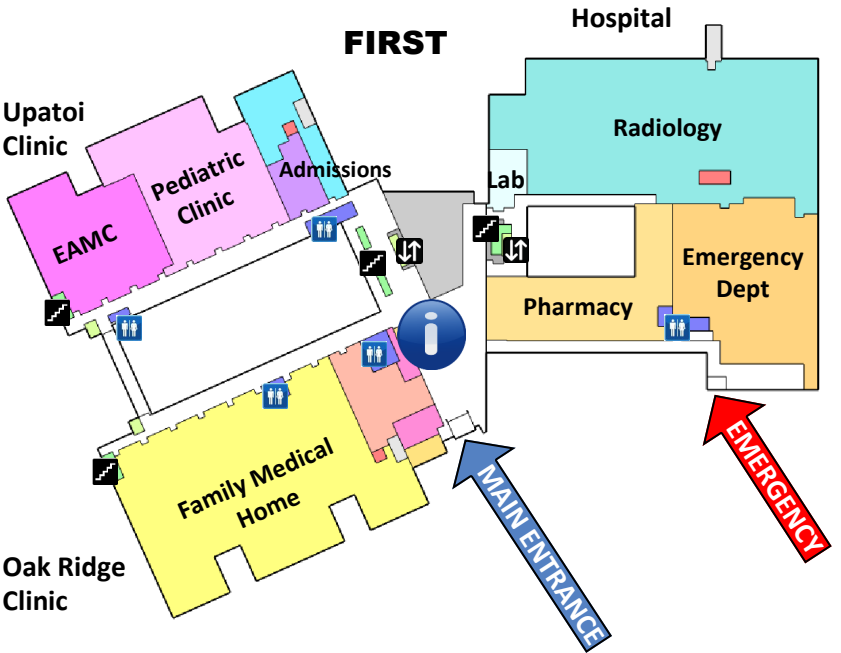

First Floor	
Hospital	Emergency Department
	Information Desk
	Pharmacy Department
	Outpatient Laboratory
Upatoi Clinic	Radiology Department
	Enhanced Adult Medicine Clinic (EAMC)
	Healthcare Management Division
	Admissions/Dispositions/Treasury (PAD)
Oak Ridge Clinic	Pediatrics Clinic
	Family Medical Home
	Healthcare Administration
	Health Benefits Advisors
	Patient Advocates
	Shopette (AAFES)

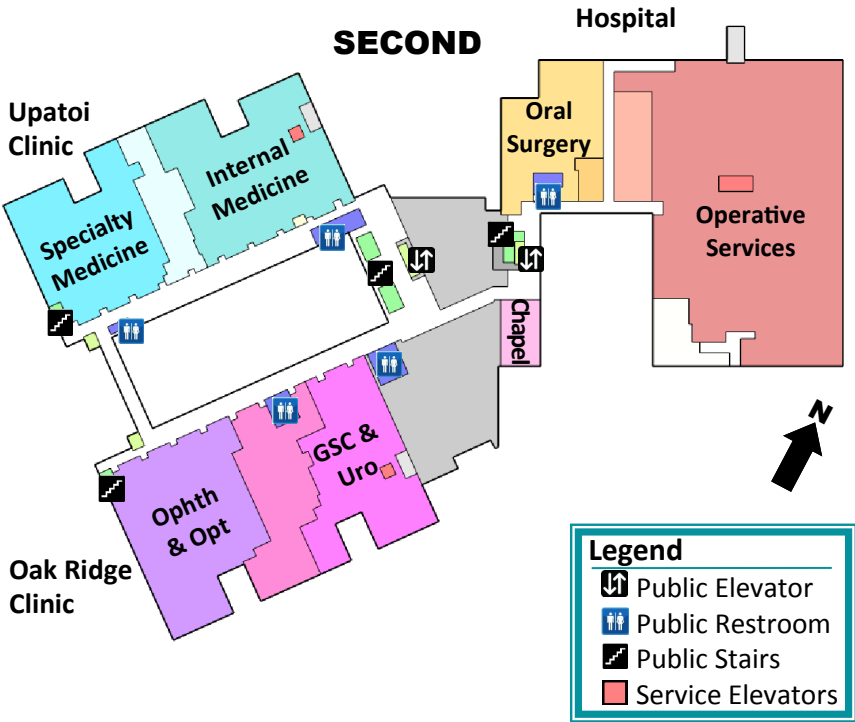

Second Floor	
Hospital	Chapel
	IDES-VA
	Oral & Maxillofacial Surgery
	Operative Services
Upatoi Clinic	Sleep Clinic
	Allergy & Immunology
	Internal Medicine
	Specialty Medicine Clinics
Oak Ridge Clinic	Ear, Nose & Throat/Audiology
	General Surgery/Urology
	Ophthalmology/Optometry